

Shadow Lane
Dental School (Bldg. A)
First Floor Plan

PLANNING & CONSTRUCTION
4505 MARYLAND PARKWAY
LAS VEGAS, NEVADA 89154
PHONE (702) 896-2500

UNIVERSITY
of
NEVADA,
LAS VEGAS



Not to Scale

File: slsdt-1.dwg

Date: 06/24/13

Sheet:

SLDS

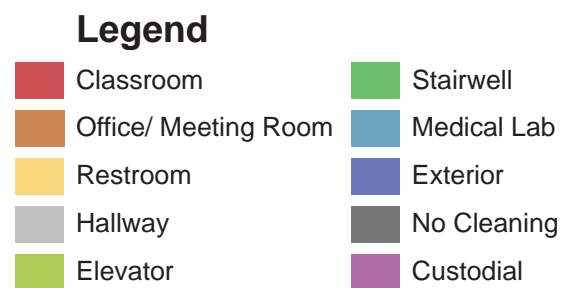



- Legend**
- | | |
|----------------------|--------------------|
| Classroom | Stairwell |
| Office/ Meeting Room | Dental/Medical Lab |
| Restroom | Exterior |
| Hallway | No Cleaning |
| Elevator | Custodial |

Shadow Lane Biotech /
Cancer Institute (Bldg B)
First Floor Plan

PLANNING & CONSTRUCTION
4505 MARYLAND PARKWAY
LAS VEGAS, NEVADA 89154
PHONE (702) 896-2500

UNIVERSITY
of
NEVADA,
LAS VEGAS





Legend

- | | |
|----------------------|-------------|
| Classroom | Stairwell |
| Office/ Meeting Room | Medical Lab |
| Restroom | Exterior |
| Hallway | No Cleaning |
| Elevator | Custodial |

Shadow Lane Biotech /
Cancer Institute (Bldg B)
Second Floor Plan

PLANNING & CONSTRUCTION
4505 MARYLAND PARKWAY
LAS VEGAS, NEVADA 89154
PHONE (702) 896-2500

UNIVERSITY of
NEVADA,
LAS VEGAS



Date: 10/26/2016

File: SLBR2-1.dwg

Not to Scale

Sheet:

SLBR



Note:
- Rooms 305, 307, 307A, 307 B, and 311, floors once a week only.

- Legend**
- | | |
|----------------------|-------------|
| Classroom | Stairwell |
| Office/ Meeting Room | Medical Lab |
| Restroom | Exterior |
| Hallway | No Cleaning |
| Elevator | Custodial |

Shadow Lane Biotech /
Cancer Institute (Bldg B)
Third Floor Plan

PLANNING & CONSTRUCTION
4505 MARYLAND PARKWAY
LAS VEGAS, NEVADA 89154
PHONE (702) 896-2500

UNIVERSITY
of
NEVADA,
LAS VEGAS



Date: 10/26/16

File: SLBR3-1.dwg

Sheet:

Not to Scale

SLBR

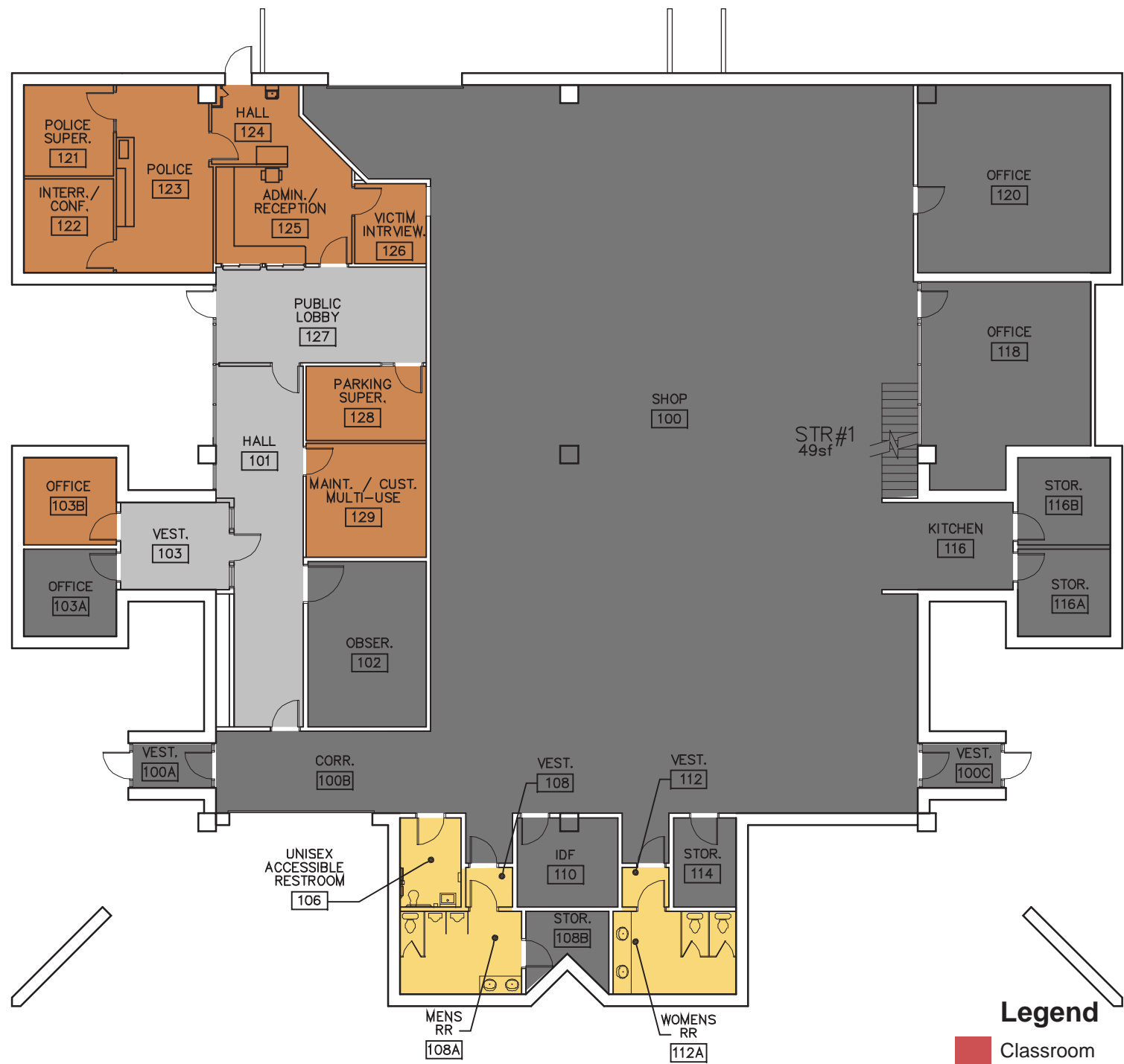

Note:
- Police offices upon request only (Rooms 103B, 121, 122, 126, and 129).

Legend

- | | |
|--|---|
| ■ Classroom | ■ Stairwell |
| ■ Office/ Meeting Room | ■ Medical Lab |
| ■ Restroom | ■ Exterior |
| ■ Hallway | ■ No Cleaning |
| ■ Elevator | ■ Custodial |

UNIVERSITY of
NEVADA,
LAS VEGAS



PLANNING & CONSTRUCTION
4505 MARYLAND PARKWAY
LAS VEGAS, NEVADA 89154
PHONE (702) 896-2500

Shadow Lane Campus
Maintenance Building (Bldg. d)
First Floor Plan

Sheet:

Date: 07/17/14

File: SLCSI-1.dwg

1/16"=1'-0"

SLCS

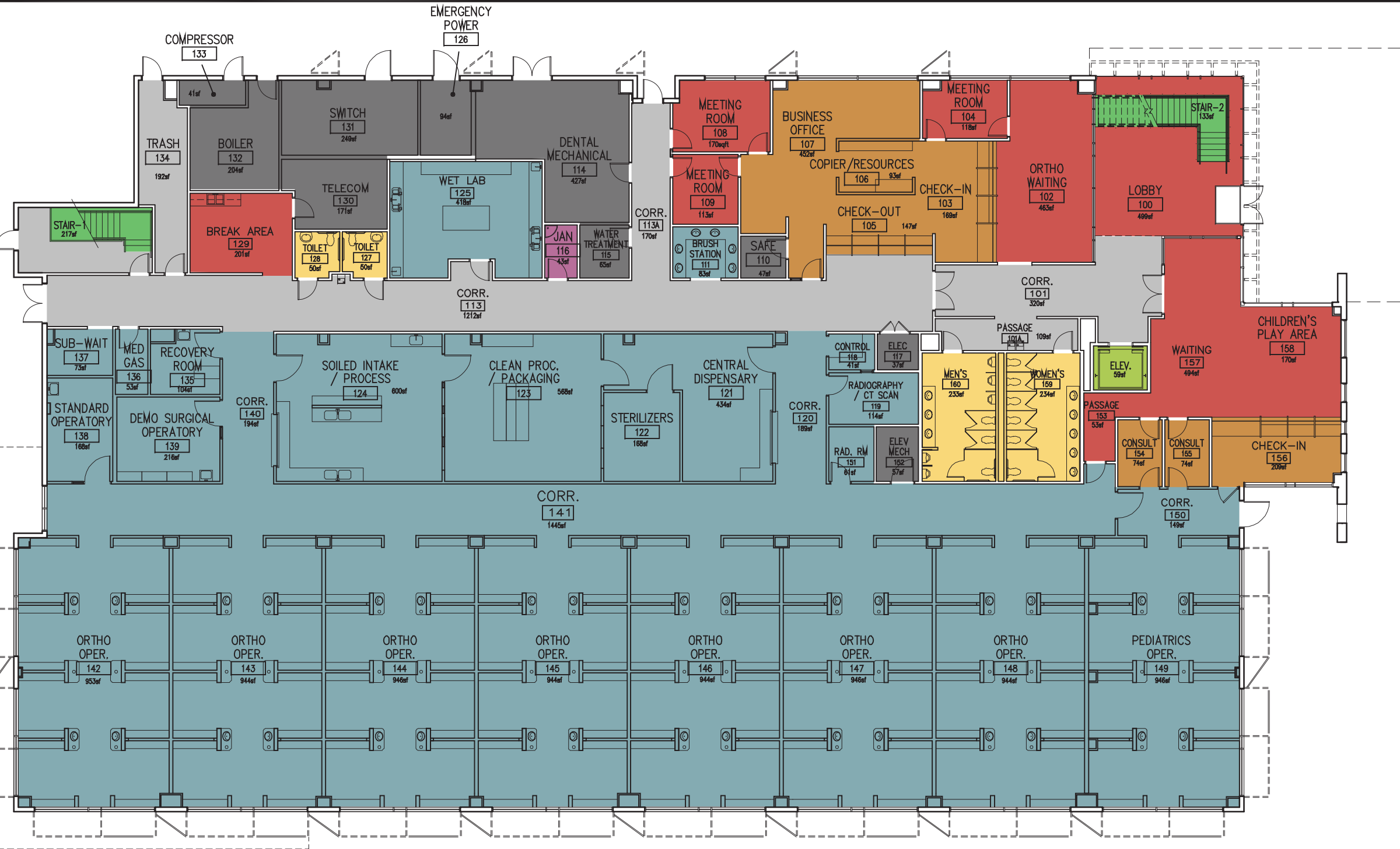

Legend

- | | |
|--|--|
| ■ Classroom | ■ Stairwell |
| ■ Office/ Meeting Room | ■ Medical Lab |
| ■ Restroom | ■ Exterior |
| ■ Hallway | ■ No Cleaning |
| ■ Elevator | ■ Custodial |

Shadow Lane Campus Bldg. D
Advanced Dental
First Floor Plan

PLANNING & CONSTRUCTION
4505 MARYLAND PARKWAY
LAS VEGAS, NEVADA 89154
PHONE (702) 896-2500

UNIVERSITY of
NEVADA,
LAS VEGAS



Date: 04/07/10

File: SLOC1-1.dwg

Not to Scale

SLOC



Legend

- | | |
|---|--|
| Classroom | Stairwell |
| Office/ Meeting Room | Medical Lab |
| Restroom | Exterior |
| Hallway | No Cleaning |
| Elevator | Custodial |

Shadow Lane Campus Bldg. D
Advanced Dental
Second Floor Plan

PLANNING & CONSTRUCTION
4505 MARYLAND PARKWAY
LAS VEGAS, NEVADA 89154
PHONE (702) 896-2500

of
UNIVERSITY
NEVADA,
LAS VEGAS



Date: 04/07/10

File: SLOC2-1.dwg

Not to Scale

SLOC



Note:
- Kick mop once a week.

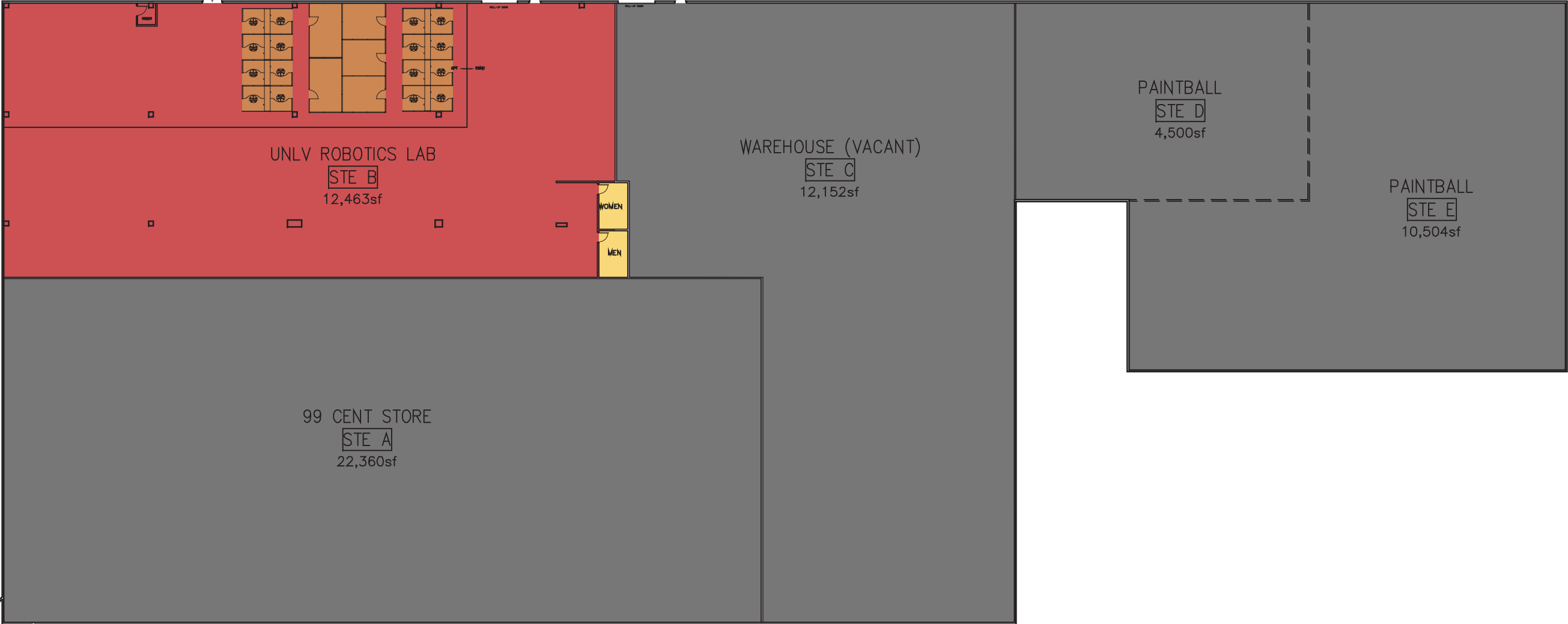

- Legend**
- | | |
|----------------------|-------------|
| Classroom | Stairwell |
| Office/ Meeting Room | Medical Lab |
| Restroom | Exterior |
| Hallway | No Cleaning |
| Elevator | Custodial |



UNIVERSITY
of
NEVADA,
LAS VEGAS

PLANNING & CONSTRUCTION
4505 MARYLAND PARKWAY
LAS VEGAS, NEVADA 89154
PHONE (702) 896-2500

Flamingo Auxiliary Building
Floor Plan

Sheet:

Date: 05/07/2015

File: Arc1.dwg

Not to Scale

ARC

- Legend**
- | | |
|---|--|
| ■ Classroom | ■ Stairwell |
| ■ Office/ Meeting Room | ■ Medical Lab |
| ■ Restroom | ■ Exterior |
| ■ Hallway | ■ No Cleaning |
| ■ Elevator | ■ Custodial |



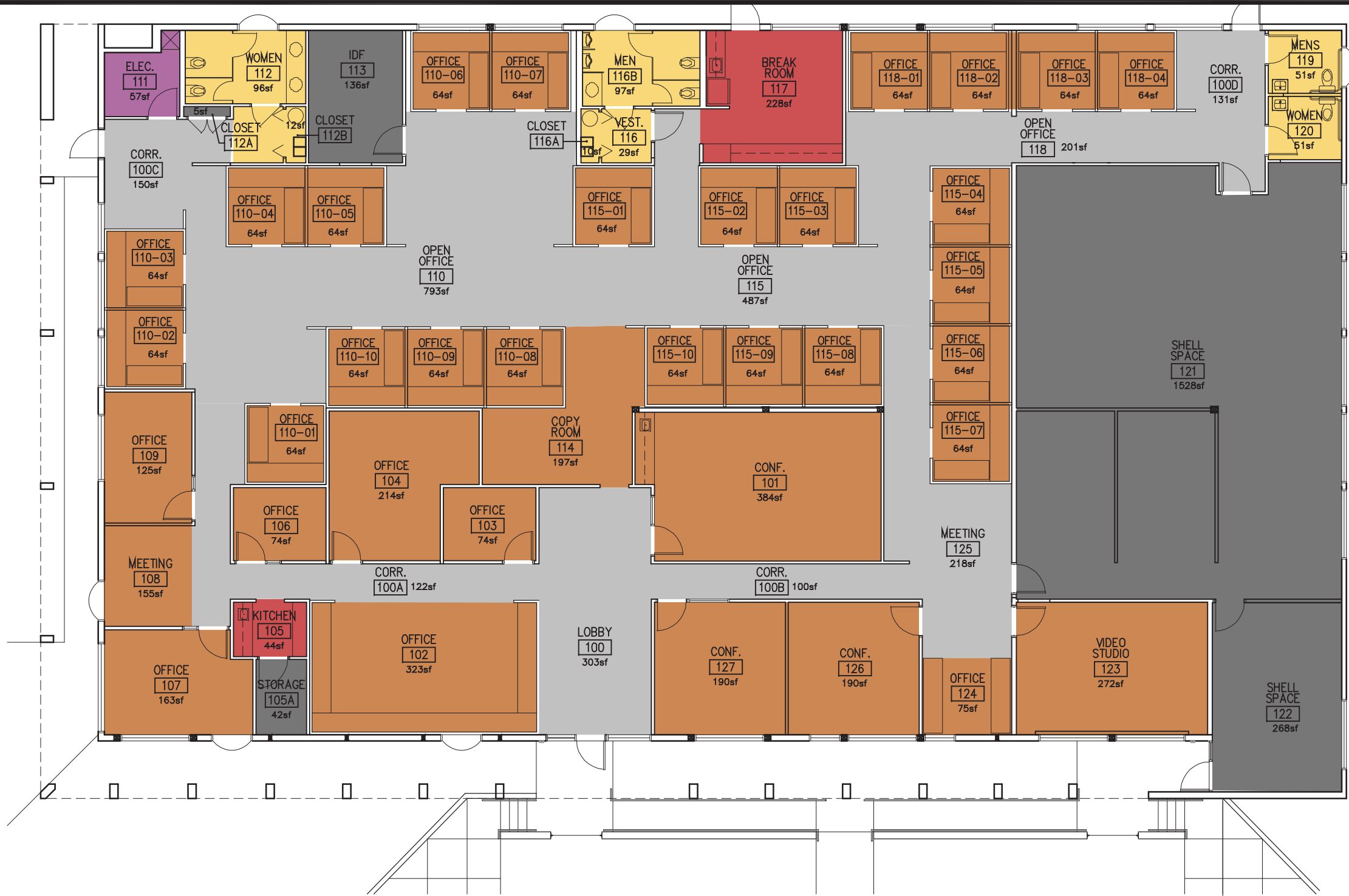

Legend

- | | |
|--|--|
| ■ Classroom | ■ Stairwell |
| ■ Office/ Meeting Room | ■ Medical Lab |
| ■ Restroom | ■ Exterior |
| ■ Hallway | ■ No Cleaning |
| ■ Elevator | ■ Custodial |



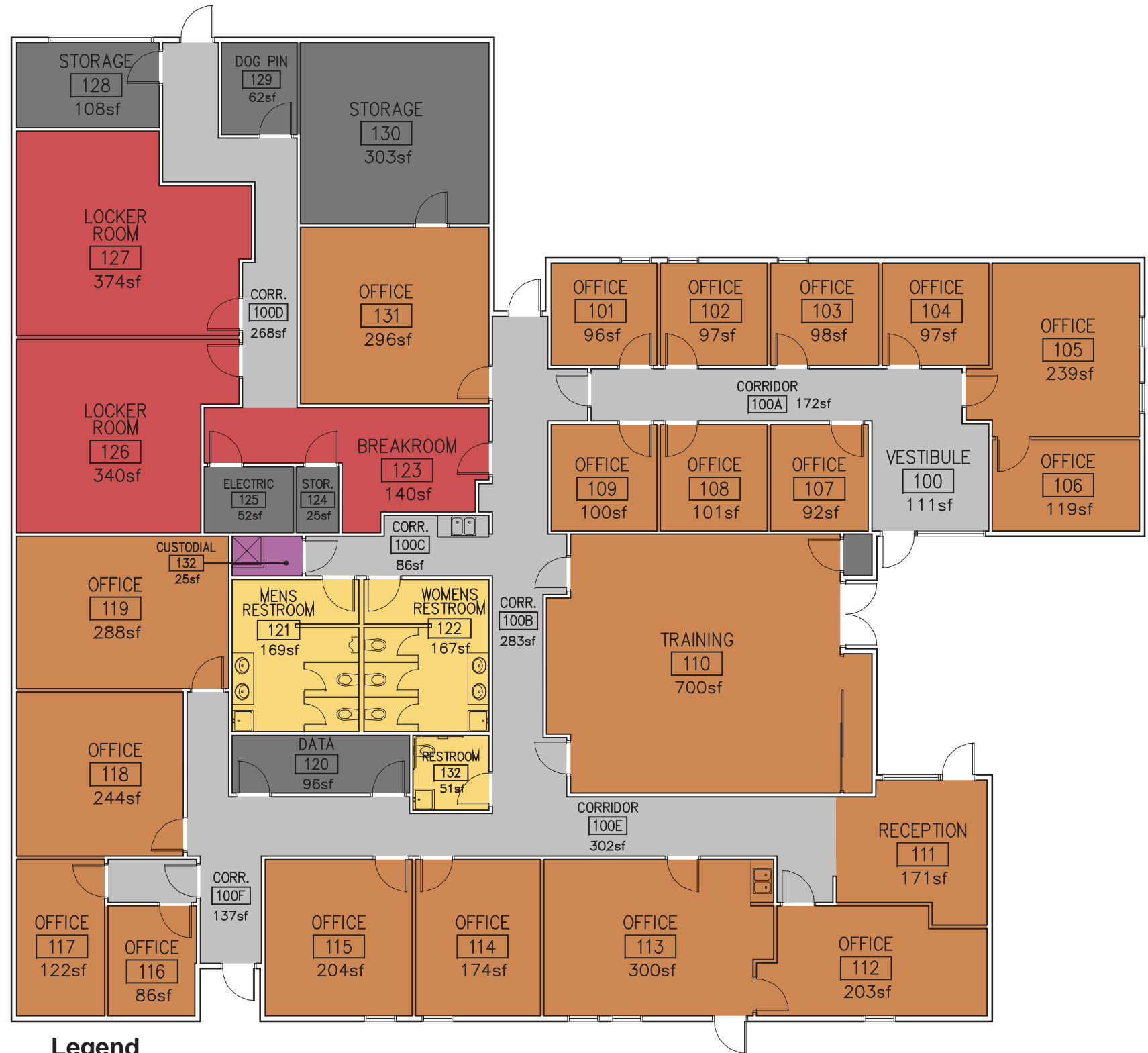

Legend

■ Classroom	■ Stairwell
■ Office/ Meeting Room	■ Medical Lab
■ Restroom	■ Exterior
■ Hallway	■ No Cleaning
■ Elevator	■ Custodial

Notes:

- Background check Required - Police Station.
- Cleaning to be done before 6 pm.
- Police offices on request only - escort required.